

3.0 Proposals

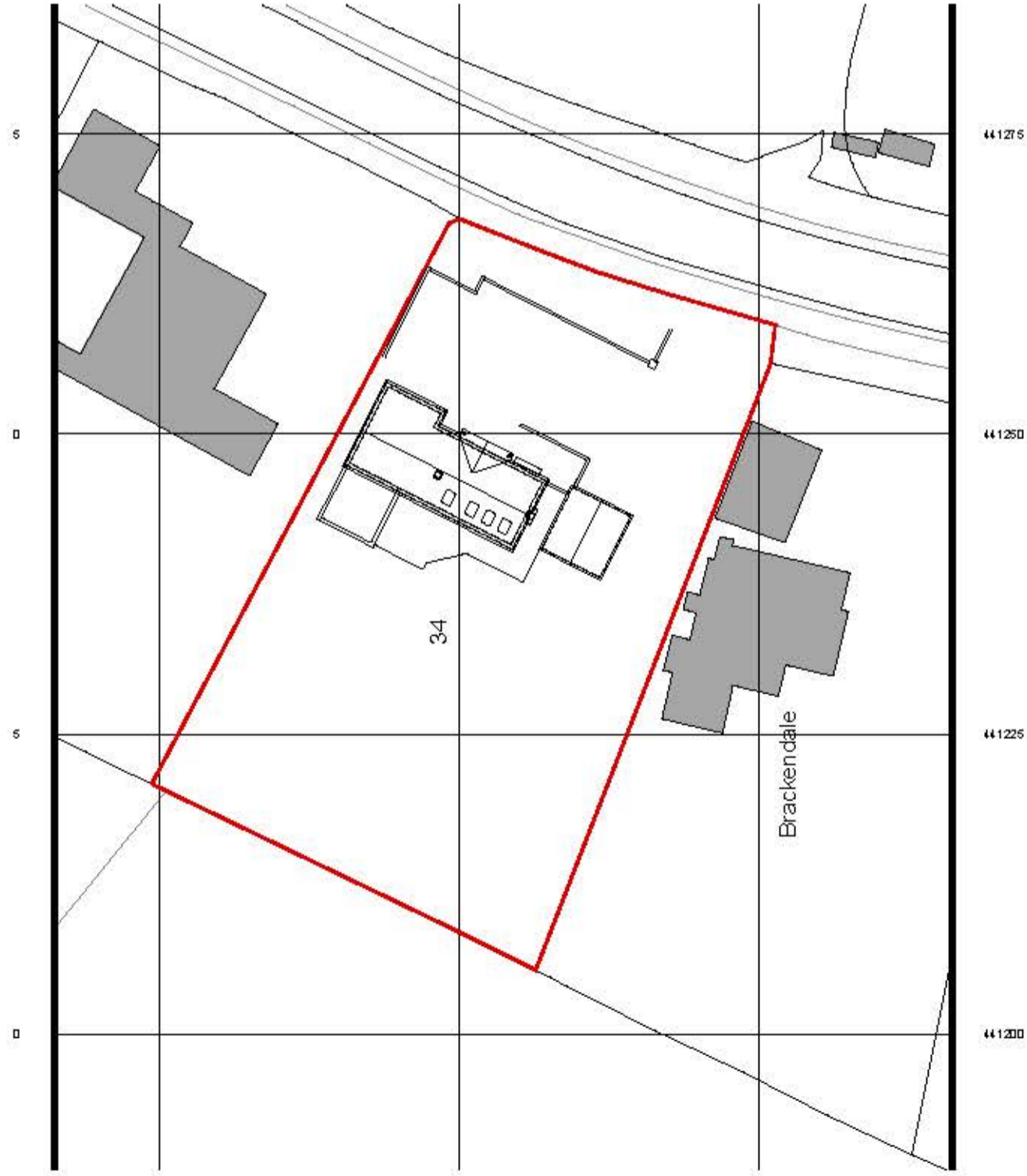

Existing Site plan 1:500

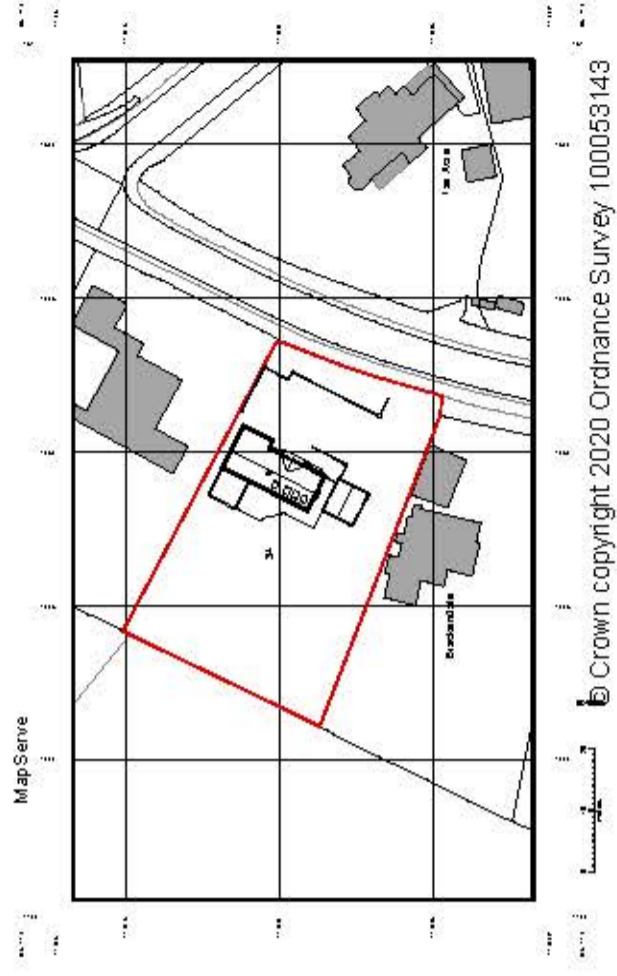

Location Plan 1:1250

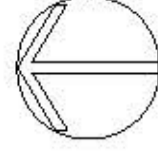

Rev -

Client Mr P Kou	Planning	
	Project Re-spective application for 24 Haddon Way, Chisworth, Southampton, SO16 7HX	Planning No. 0213-02-101
Title Site location plan	Drawn nb checked	Scale 1:1250 & 1:500 002
	Issue 1	Revision Sept 2020

bircharchitects
Lambourne, Grove Lane, Redlynch, Salisbury, Wiltshire, SP5 2NR
T: +44 (0)1725 510407
E: info@bircharchitects.co.uk